

## AC-10-EM Actuator

Large handle · Flush mount · Electronic actuation

### Features

- Electronic lock/unlock offers convenient keyless access
- Flush mount design limits catch points and improves industrial design
- Corrosion-resistant material suitable for heavy duty applications
- Sealed lock/unlock actuator resists the elements

### Installation Notes

- Installation torque of mounting nuts not to exceed 7 N.m
- Mounting nut (M6 x 1) not supplied
- AC-10 can only use snub end coupling (type 6 or 7 cable)

### Material

- Housing, handle, rotating linkage: Glass-filled reinforced nylon, black
- Threaded stud and cable bracket retainers: Steel, zinc nickel
- Housing and handle gaskets: Adhesive backed foam, black

### Electronic Actuator Information

- Voltage: 12 V ±1.2 V
- Current: 2.5 A - 3 A
- Pulse Duration: 225 ms ± 25 ms



### Multi-Point With Cable Bracket and Lock/Unlock Electronic Actuator

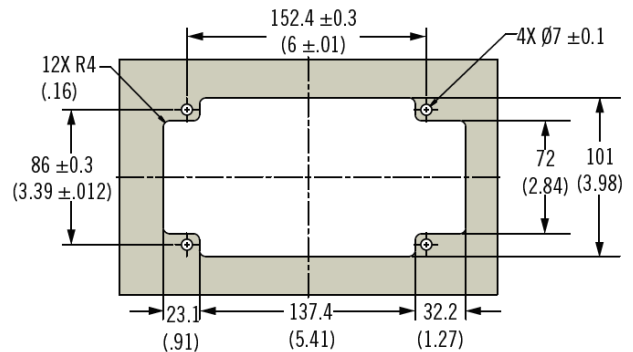
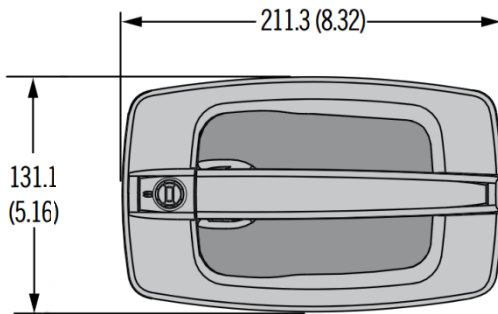
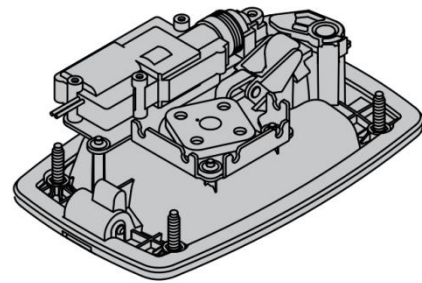
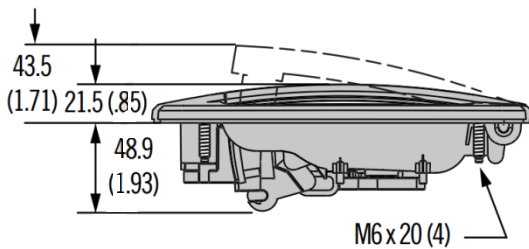

### S Actuation Style

EM-3 Multi-Point, with Cable Bracket and Electronic Lock/Unlock

### L Locking Options

- 1 Reversible key (No keys - R001)
- 2 Reversible key (2 keys included - R001)
- 3 Reversible key (keyed differently - 2 keys included)
- 4 Standard key (No keys - CH751)
- 5 Standard key (2 keys included - CH751)
- 6 Standard key (keyed differently - 2 keys included)
- 7 Reversible Key (2 keys included - 14603)
- 9 No Lock Plug installed

AC - 10 - S L 1 - 11 - KC

### KC Key Codes

(Omit for Locking Options 0, 1, 2, 4, 5 and 9)  
\*KD10 Keyed Differently (Only used if L = 3 or 6)  
\*MK10 Master Keyed Differently (Only used if L = 6)

\*Supplied in multiples of 10 with 10 different key codes.

### Notes

- For use with rods / cables, recommended snap-in retainer for rotator plate: R4-0-43922
- Contact Gripwell for lock core selection and detailed key information